

ROYAL

METAL UPRIGHTS

Models: 6800

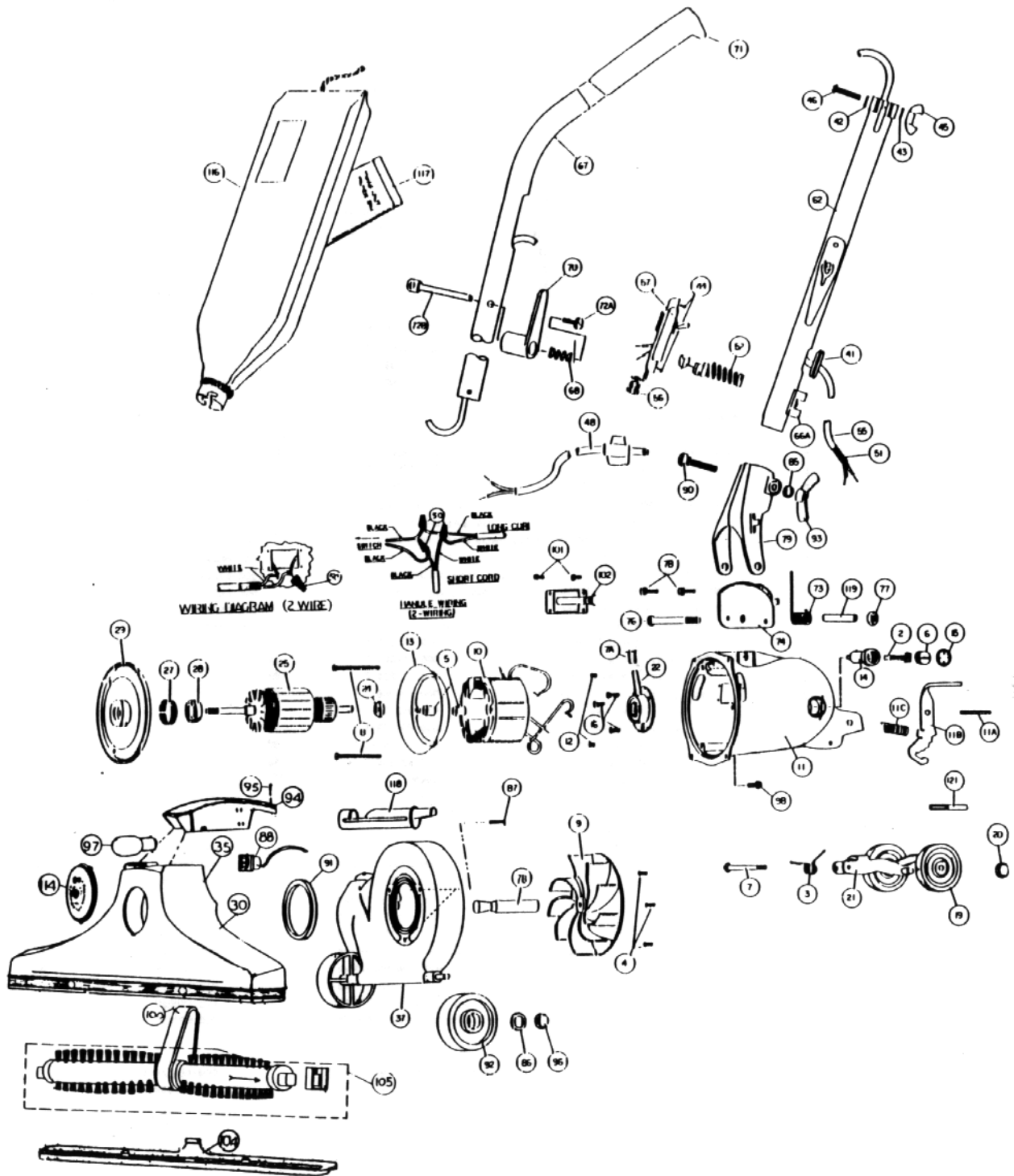

Models: 6800

NLA	Motor Unit Assy	66A	R-670844	Cord, clip	
2	R-672105	Carbon Brush Assy	67	R-0887328	Upper Handle Assembly
3	R-003008	Spring, rear fork	68	R-003884	Spring
4	R-670013	Screw, motor plate ret.	70	R-259318	Upper Cord Hook
5	R-618772	Baffle Spacer	71	R-801314	Handle Grip
6	R-672103	Brush Holder & Screw Assembly	72A	R-597743	Screw
7	R-311031	Screw & Washer Assembly	72B	R-884708	Eye Bolt
7A	R-065028	Oiler Cap	73	R-004723	Spring, handle fork
7B	R-380261	Drive Shaft	74	R-133714	Handle Stop Plate
8	R-618016	Screw, field retainer	76	R-801708	Bolt, handle fork retainer
9	R-608005	Fan, heavy duty	77	R-801714	Nut, nylon insert
10	R-780002	Field, 120v	78	R-990104	Screw, handle stop plate
11	NLA	Motor Housing Assembly	79	R-028580	Handle, Fork & Latch Assembly
11A	R-670705	Spring Pin	85	R-003311	Washer, handle fork clamp screw
11B	R-690715	Release Pedal	86	R-005138	Washer, wheel retainer
11C	R-672009	Spring, release pedal	87	R-023309	Screw, wheel retainer
12	R-801014	Set Screw, brush holder	88	R-060265	Headlight, Socket & Sleeve Assembly
13	R-801017	Baffle Plate	90	R-230713	Carriage Bolt, handle clamp
14	R-801019	Brush Holder	91	R-2854270	Gasket, nozzle sealing
15	R-801034	Brush Holder Protector Cap	92	R-880705	Wide Front Wheel, 2 1/2" diam.
16	R-801701	Screw, rear bearing retainer	93	R-285720	Wingnut, large
	R-082105	Rear Wheel, Fork & Shaft Assy	94	NLA	Headlight Stamping
19	R-880705	Wheel, 2 1/2" diam.	95	NLA	Screw, headlight stamp retainer
20	NLA	Wheel Retainer	96	NLA	Wheel Retainer
21	R-670007	Rear Fork & Shaft Assembly	97	R-880629	Headlight Bulb
22	R-080126	Rear Bearing Assembly	98	R-980743	Screw, machine-thread forming
	R-088407	Motor Plate & Armature Assy	100	R-044260	Belt
24	R-175053	Washer, oil slinger	101	R-360753	Screw, side connections plate
25	R-680001	Armature, 120v	102	R-183749	Side Connection Plate
	NLA	Motor Plate & Bearing Assy	101	R-360753	Screw, side connection plate
27	R-880046	Tolerance Ring	104	R-672270	Nozzle Guard
28	R-880026	Ball Bearing	105	NLA	Brush Roll Assembly
29	R-884003	Motor Plate	114	R-088169	Adjust-O-Rite Plate
30	NLA	Nozzle Assembly	116	NLA	Bag Assembly, zipper
35	NLA	Nozzle Casting	117	R-66247	Paper Bag
37	R-101161	Fancase Assembly	118	R-880262	Belt Lifter
	R-099430A	Handle & Cord Assembly	119	R-110773	Insert, motor housing
41	R-230324	Grommet	121	R-1300086	Cover, lever
42	R-003311	Lockwasher			
43	R-023311	Lockwasher			
44	R-801701	Screw, switchplate			
45	R-801710	Wingnut, small			
46	R-801712	Screw, adaptor clamp			
	NLA	Switch & Cord Assembly			
48	R-028537	Cord & Plug Assembly			
50	R-259761	Wire Connector			
51	NLA	Cord Protecting Sleeve			
52	R-322305	Strain Relief, switch plate			
55	NLA	Short Cord			
56	R-880305	Strain Relief			
57	R-028537	Switch & Plate Assembly			
62	R-0655330	Handle Adaptor Assembly			